

WELCOME  
TO A  
*different*  
PLACE





# YOUR GUIDE TO *all things* HYATT PLACE

## HYATT PLACE MELBOURNE ESSENDON FIELDS

### HOTEL FEATURES

- 24/7 Gallery
- Daily & long term parking
- 12 noon check out time
- Free airport shuttle to & from Melbourne International Airport
- Free WiFi & remote printing
- Meeting space suitable for 6-50 guests
- Odds & Ends available for guests to buy, borrow or enjoy for free
- 24-hour StayFit gym
- Express checkout option
- 100% smoke-free
- Hyatt Place Event Centre catering up to 1400 guests

### ROOMY ROOMS

- 166 guestrooms
- Twin share & King rooms available
- Hyatt Grand Bed
- 49" flat screen HDTV with Chromecast
- Cozy Corner in each room
- Individual air-conditioning
- Mini-fridge
- Tea / coffee making facilities
- Cordless telephone with voicemail
- Hair dryer
- Iron / ironing board
- KenetMD skin and hair care amenities
- Large workdesk
- In-room safe

### 24/7 EAT & DRINK

- Gallery Kitchen Breakfast includes hot breakfast items, fresh fruit and more
  - Weekdays 6:30-10:00 a.m.
  - Weekends 7:00-10:00 a.m.
- 24/7 Gallery Menu offers freshly prepared meals any time day or night
- Grab n' Go items available 24/7 from the Gallery Market
- Barrista coffee available all day
- Gallery Bar serving a variety of beer, wine and spirits

### EARN FREE NIGHTS

- Join the World of Hyatt - the loyalty program that revolves around you. Enjoy free nights, member discounts, exclusive offers and more. Visit [worldofhyatt.com](http://worldofhyatt.com)

### EXPLORE

- DFO Essendon - 2.6kms
- Westfield Airport West Shopping Centre - 2kms
- Keilor Road Dining Precinct - 2.2kms
- Melbourne CBD - 10kms
- Flemington Racecourse - 12.3kms
- Melbourne Zoo - 12.5kms
- Melbourne Cricket Ground - 20.6kms

NOW OVER 175 *hotel locations* AND COUNTING, SO YOU'LL NEVER HAVE  
TO SETTLE FOR ANY PLACE LESS THAN HYATT PLACE

# THE *perfect* MEETING NEEDS THE *perfect* PLACE

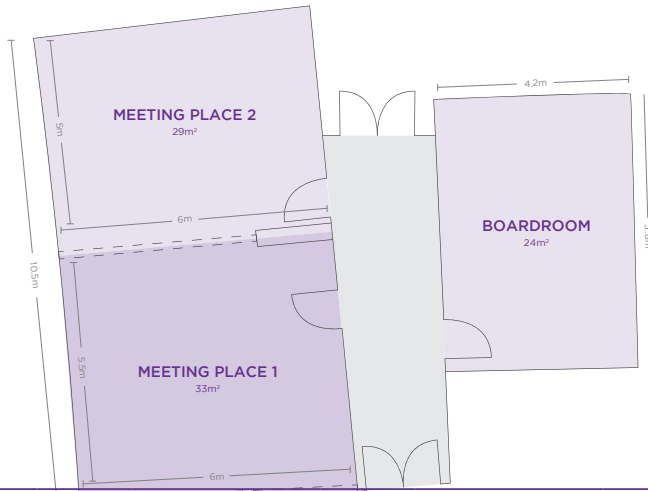

Room & Dimensions	Conference	Banquet	Class Room	Theatre	U-Shape	Hollow Square	Cocktail	Cabaret
<b>MEETING PLACE 1</b> 5.5m x 6.0m (33m <sup>2</sup> )	12	30	12	24	9	12	45	24
<b>MEETING PLACE 2</b> 5.0m x 6.0m (29m <sup>2</sup> )	12	20	12	18	9	12	35	16
<b>MEETING PLACE 1 &amp; 2</b> 10.5m x 6.0m (62m <sup>2</sup> )	30	50	24	42	24	24	80	40
<b>BOARDROOM</b> 5.8m x 4.2m (24m <sup>2</sup> )	10	-	-	-	-	-	-	-

## MEETINGS & EVENTS

- Flexible meeting and break out spaces
- Unique catering options
- In-built audiovisual equipment
- Dedicated meeting planner to manage every detail

## CATERING

- Hot and cold breakfast options
- Business or casual plated lunch options
- Quick bites and beverages for break time
- Reception packages

TO FIND OUT MORE ABOUT PLANNING YOUR NEXT EVENT, CALL +61 3 9190 1247

# THE *perfect* EVENT NEEDS THE *perfect* PLACE

## *floorplan*

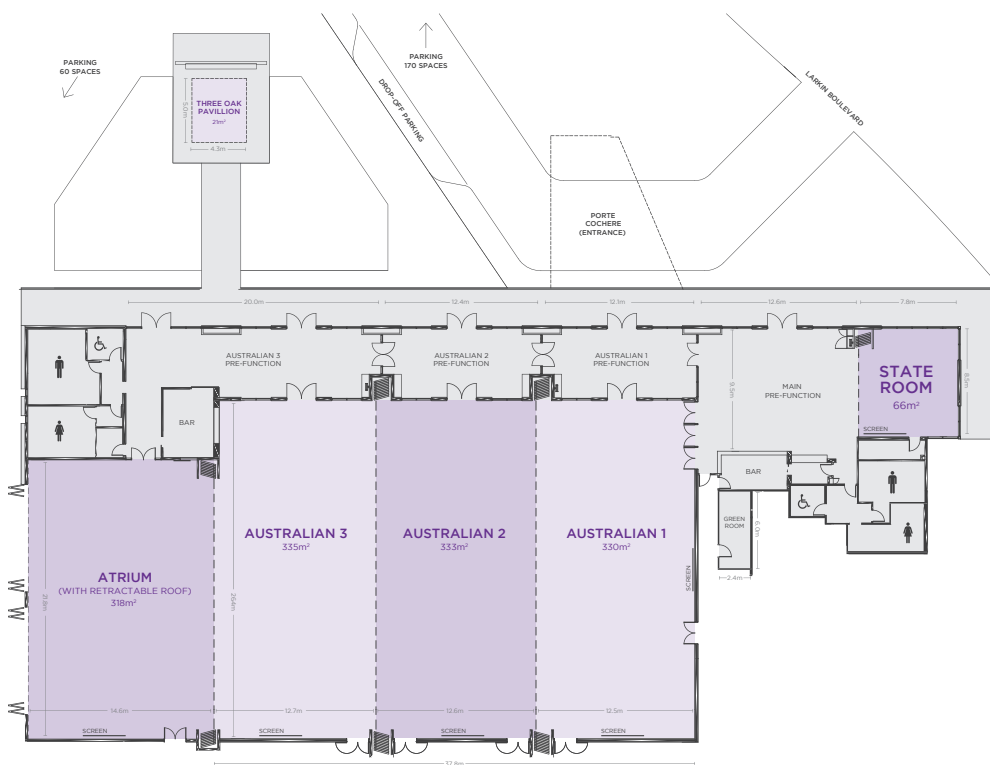

# room capacities

Room & Dimensions	Theatre	Banquet	Cabaret	Banquet + Dancefloor	Exhibition/ Tradeshow	Cocktail	Classroom	U-Shape
<b>STATE ROOM</b> 8.5m x 7.8m (66m <sup>2</sup> )	65	40	32	-	-	50	-	20
<b>AUSTRALIAN 1</b> 26.4m x 12.5m (330m <sup>2</sup> )	360	210	144	170	29	320	168	48
<b>AUSTRALIAN 2</b> 26.4m x 12.6m (333m <sup>2</sup> )	360	210	144	170	30	320	168	32
<b>AUSTRALIAN 3</b> 26.4m x 12.7m (335m <sup>2</sup> )	360	210	144	170	30	320	168	32
<b>ATRIUM</b> 21.8m x 14.6m (318m <sup>2</sup> )	320	240	160	160	23	310	135	36
<b>AUSTRALIAN 1 &amp; 2</b> 26.4m x 25.1m (665m <sup>2</sup> )	820	480	336	440	40	640	336	68
<b>AUSTRALIAN 2 &amp; 3</b> 26.4m x 25.3m (668m <sup>2</sup> )	820	480	336	440	40	640	336	68
<b>AUSTRALIAN 3 &amp; ATRIUM</b> 26.4m x 12.7m & 21.8m x 14.6m (653m <sup>2</sup> )	600	450	304	320	36	600	320	72
<b>THREE OAK PAVILION</b> 5.0m x 4.3m (21m <sup>2</sup> )	50	-	-	-	-	100	-	-
<b>AUSTRALIAN 1, 2 &amp; 3</b> 26.4m x 52.4m (998m <sup>2</sup> )	1,220	730	511	600	83	840	-	-
<b>AUSTRALIAN 1, 2, 3 &amp; ATRIUM</b> 21.8m x 14.6m & 26.4m x 52.4m (1,316m <sup>2</sup> )	-	1,000	700	800	100	1,200	-	-

## CONFERENCES, EXHIBITIONS & EVENTS

- Maximum flexibility
- Pillarless spaces
- Meetings & All day Conferences

## CATERING

- World Class Chefs
- Seasoned Menus
- Local Produce

TO FIND OUT MORE ABOUT PLANNING YOUR NEXT EVENT, CALL +61 3 9190 1247

NOW OVER 175 *hotel locations* AND COUNTING, SO YOU'LL NEVER HAVE TO SETTLE FOR ANY PLACE LESS THAN HYATT PLACE

