



OVERVIEW



HYATT HOTEL CANBERRA – *A Park Hyatt Hotel* *Combines grand elegance with contemporary quality and comfort.*

Since opening its doors in 1924, Hotel Canberra (Hyatt Hotel Canberra) has welcomed heads of state, captains of industry, and well-heeled travelers from near and far.

With its newly renovated guest rooms and suites, and located within a short stroll or drive to numerous off-site dining and entertainment attractions, the hotel is the perfect regional destination for groups and events.

ACCOMMODATION

- 252 rooms and suites, including 13 suites
- All rooms are over 40sqm in size and feature deep soaking tubs and separate glass showers
- Over 100 rooms feature French doors and balconies
- New renovated rooms with plush carpet, warm tones, and contemporary fabrics
- Heritage-listed section featuring 6 Diplomatic Suites at 240sqm each, with views of the Thomas Weston-designed Gardens

FACILITIES & SERVICES

- The exclusive Clubhouse offers a fully equipped gymnasium, personal trainers, indoor heated pool, spa, sauna, bike hire and tennis courts
- Fitness classes including aqua fitness, mat Pilates and yoga are offered at the Clubhouse
- 24/7 Business Centre with an extensive range of free-standing services and facilities including a boardroom

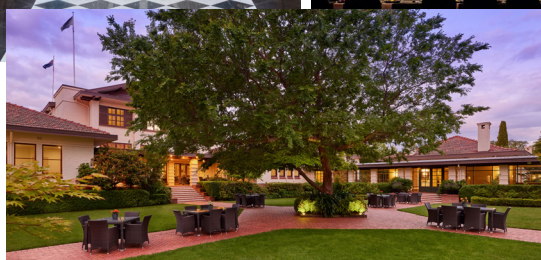
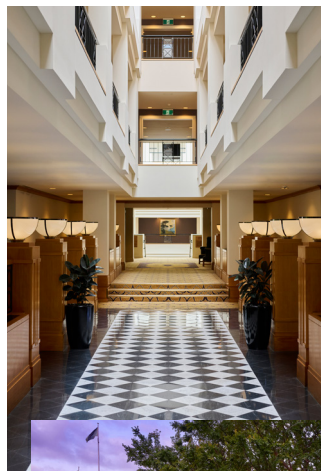



AREA ATTRACTIONS

- National Gallery of Art
- Lake Burley Griffin
- The Australian War Memorial
- The National Portrait Gallery
- The National Museum of Australia
- National Arboretum
- Canberra District Wine Region

RESTAURANTS & BARS

- The Tea Lounge, our revered lounge for dining and afternoon tea
- Speakers Bar & Griffins Lounge, enjoy a tippie by cozy fireplaces in a place where Australian history has been shaped for over 80 years
- Promenade Café, for breakfast and a la carte options

120 Commonwealth Avenue,
Canberra, Australian Capital Territory, 2600
canberra.park.hyatt.com
eventsathyatt.com/hyatt-hotel-canberra

T. +61 2 6270 1234